

NOTE:
 This drawing is copyright and is the property of Solari Architects Limited and must not be used without written authorisation. Do not scale this drawing. All dimensions are to be verified on site and any discrepancies reported before commencement of any work or shop drawings.

Material references on this drawing are generic only - unless specifically stated.

All construction works must be carried out by suitably qualified tradespeople and must be in strict accordance with all territorial authority requirements and consent conditions.

Revision Date Description

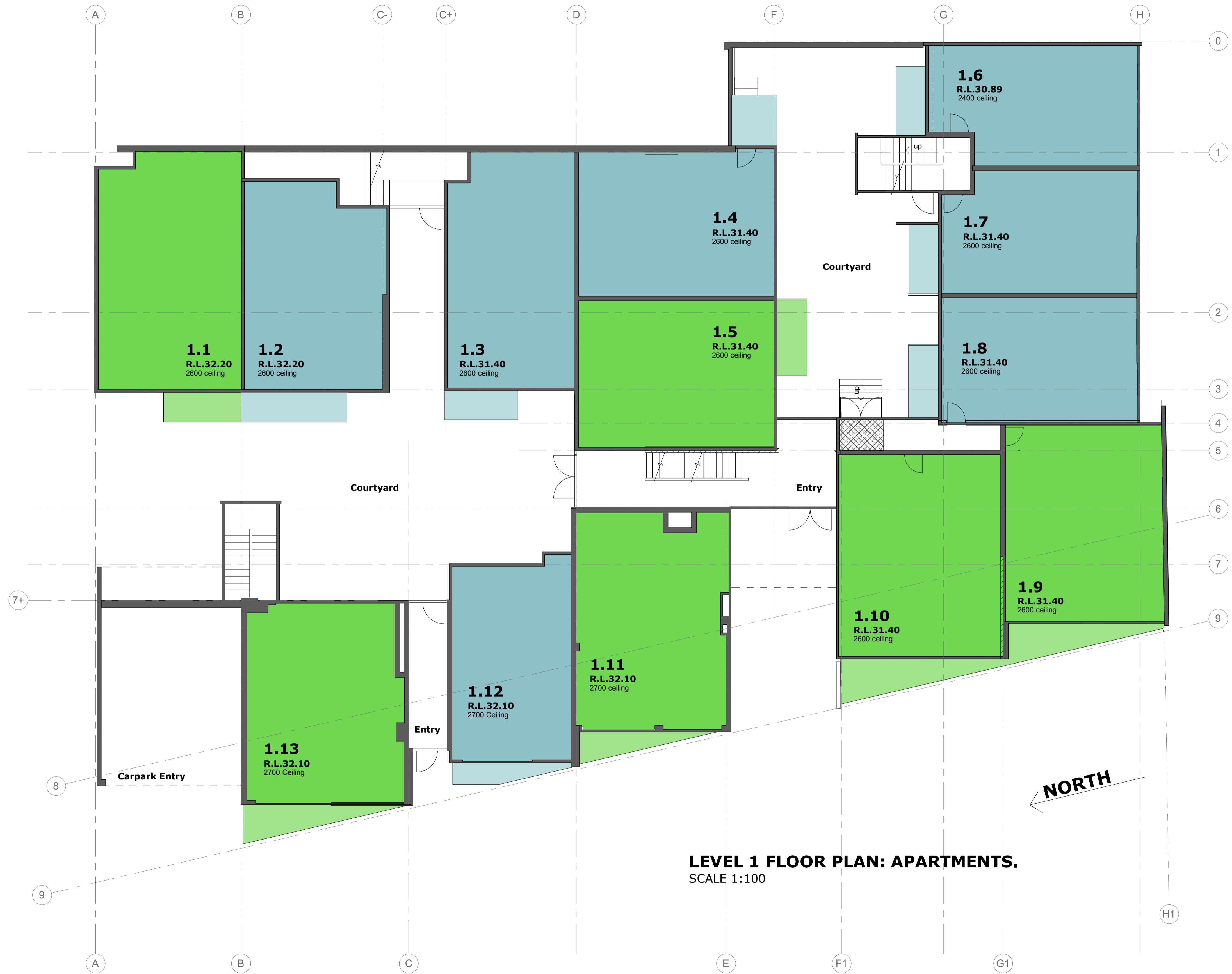

- TWO BEDROOM UNIT
- BALCONY
- THREE BEDROOM UNIT
- BALCONY

NOTE: Areas are approximate and as measured on the architectural drawings. Final constructed areas can be subject to minor variation as a result of normal constructional anomalies. If a final as-built area is required, this would need to be undertaken by means of an "as-built" survey at the completion of construction. Areas are measured to inside face of external walls, and to the centreline of intertenancy walls.

LEVEL 1 FLOOR PLAN: APARTMENTS.
 SCALE 1:100

Project **Detroit Apartments Stage 2**
 Client **181 TASMAN STREET**
 Address **181 TASMAN STREET, MT COOK WELLINGTON**

Drawing **Floor Plan L1 Areas**
 Date **28/05/15**
 Scale **1 : 100**
 Drawing Issue **FOR CONSTRUCTION**

Project Number
1320
 Drawing Number **A.111** Revision